

Stirnräder

geradverzahnt,
aus Polyacetal
(Hostaform C)

(Eingriffswinkel 20°)

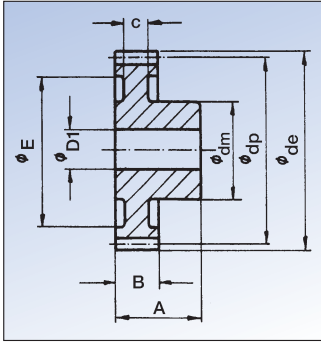

Ausführung: Gespritzt; Bohrung spanabhebend bearbeitet

Zahnbreite B:

- Modul 0,5 = 3,0 mm.
- Modul 0,7 = 6,0 mm.
- Modul 1,0 = 9,0 mm.
- Modul 1,25 = 10,0 mm.
- Modul 1,5 = 12,0 mm.
- Modul 2,0 = 15,0 mm.
- Modul 3,0 = 19,0 mm.

Gesamtbreite A:

- Modul 0,5 = $\frac{7,0}{10,0}$ (z = 12 - 14)
- Modul 0,7 = 15,0 mm.
- Modul 1,0 = $\frac{17,0}{18,0}$ (z = 12 - 23)
- Modul 1,25 = 19,0 mm.
- Modul 1,5 = 23,0 mm.
- Modul 2,0 = 27,0 mm.
- Modul 3,0 = 34,0 mm.

Zähne- zahl	Modul 1,5						Modul 2,0						Modul 3,0					
	Artikel-Nummer Ketten Fuchs																	
	SH-15- (+Zähnezahl)						SH-20- (+Zähnezahl)						SH-30- (+Zähnezahl)					
	Abmessungen in mm																	
Z	de	dp	dm	D1	E	c	de	dp	dm	D1	E	c	de	dp	dm	D1	E	c
12	21,0	18,00	14,0	6,0	-	-	28,0	24,00	18,5	8,0	-	-	42,0	36,00	24,0	12,0	-	-
13	22,5	19,50	14,0	6,0	-	-	30,0	26,00	18,5	8,0	-	-	45,0	39,00	24,0	12,0	-	-
14	24,0	21,00	14,0	6,0	-	-	32,0	28,00	18,5	8,0	-	-	48,0	42,00	24,0	12,0	-	-
15	25,5	22,50	14,0	6,0	-	-	34,0	30,00	18,5	8,0	-	-	51,0	45,00	24,0	12,0	30,0	8,0
16	27,0	24,00	14,0	6,0	-	-	36,0	32,00	17,5	8,0	23,0	6,0	54,0	48,00	24,0	12,0	30,0	8,0
17	28,5	25,50	14,0	6,0	-	-	38,0	34,00	17,5	8,0	25,0	6,0	57,0	51,00	24,0	12,0	30,0	8,0
18	30,0	27,00	17,0	8,0	-	-	40,0	36,00	17,5	8,0	26,0	6,0	60,0	54,00	24,0	12,0	38,0	8,0
19	31,5	28,50	17,0	8,0	-	-	42,0	38,00	17,5	8,0	26,0	6,0	63,0	57,00	24,0	12,0	38,0	8,0
20	33,0	30,00	17,0	8,0	-	-	44,0	40,00	20,0	10,0	29,0	6,0	66,0	60,00	24,0	12,0	38,0	8,0
21	34,5	31,50	17,0	8,0	23,0	5,0	46,0	42,00	20,0	10,0	29,0	6,0	69,0	63,00	24,0	12,0	45,0	8,0
22	36,0	33,00	17,0	8,0	23,0	5,0	48,0	44,00	20,0	10,0	29,0	6,0	72,0	66,00	24,0	12,0	45,0	8,0
23	37,5	34,50	17,0	8,0	23,0	5,0	50,0	46,00	20,0	10,0	36,0	6,0	75,0	69,00	24,0	12,0	52,0	8,0
24	39,0	36,00	19,0	8,0	27,0	5,0	52,0	48,00	24,0	10,0	36,0	6,0	78,0	72,00	24,0	12,0	52,0	8,0
25	40,5	37,50	19,0	8,0	27,0	5,0	54,0	50,00	24,0	10,0	36,0	6,0	81,0	75,00	28,0	14,0	58,0	8,0
26	42,0	39,00	19,0	8,0	27,0	5,0	56,0	52,00	24,0	10,0	40,0	6,0	84,0	78,00	28,0	14,0	58,0	8,0
27	43,5	40,50	19,0	8,0	27,0	5,0	58,0	54,00	24,0	10,0	40,0	6,0	87,0	81,00	28,0	14,0	58,0	8,0
28	45,0	42,00	19,0	8,0	27,0	5,0	60,0	56,00	24,0	10,0	40,0	6,0	90,0	84,00	28,0	14,0	68,0	8,0
30	48,0	45,00	24,0	10,0	35,0	5,0	64,0	60,00	24,0	10,0	46,0	6,0	96,0	90,00	28,0	14,0	68,0	8,0
32	51,0	48,00	24,0	10,0	35,0	5,0	68,0	64,00	26,0	10,0	46,0	6,0	102,0	96,00	32,0	16,0	71,0	8,0
33	-	-	-	-	-	-	-	-	-	-	-	-	105,0	99,00	32,0	16,0	71,0	8,0
35	55,5	52,50	24,0	10,0	43,0	5,0	74,0	70,00	26,0	12,0	56,0	6,0	111,0	105,00	32,0	16,0	80,0	8,0
36	57,0	54,00	24,0	10,0	43,0	5,0	76,0	72,00	26,0	12,0	56,0	6,0	-	-	-	-	-	-
38	60,0	57,00	24,0	10,0	43,0	5,0	80,0	76,00	26,0	12,0	64,0	6,0	120,0	114,00	32,0	16,0	89,0	8,0
40	63,0	60,00	24,0	10,0	50,0	5,0	84,0	80,00	26,0	12,0	64,0	6,0	126,0	120,00	32,0	16,0	95,0	8,0
42	66,0	63,00	24,0	10,0	50,0	5,0	88,0	84,00	26,0	12,0	64,0	6,0	-	-	-	-	-	-
45	70,5	67,50	24,0	10,0	50,0	5,0	94,0	90,00	30,0	14,0	70,0	6,0	141,0	135,00	32,0	16,0	110,0	8,0
48	75,0	72,00	24,0	10,0	50,0	5,0	100,0	96,00	30,0	14,0	76,0	6,0	-	-	-	-	-	-
50	78,0	75,00	27,0	12,0	65,0	5,0	104,0	100,00	30,0	14,0	80,0	6,0	-	-	-	-	-	-
52	81,0	78,00	27,0	12,0	65,0	5,0	-	-	-	-	-	-	-	-	-	-	-	-
54	84,0	81,00	27,0	12,0	65,0	5,0	-	-	-	-	-	-	-	-	-	-	-	-
55	85,5	82,50	27,0	12,0	65,0	5,0	114,0	110,00	30,0	14,0	90,0	6,0	-	-	-	-	-	-
56	-	-	-	-	-	-	-	-	-	-	-	-	-	-	-	-	-	-
58	-	-	-	-	-	-	-	-	-	-	-	-	-	-	-	-	-	-
60	93,0	90,00	27,0	12,0	65,0	5,0	124,0	120,00	30,0	14,0	100,0	6,0	-	-	-	-	-	-
64	-	-	-	-	-	-	-	-	-	-	-	-	-	-	-	-	-	-
65	-	-	-	-	-	-	-	-	-	-	-	-	-	-	-	-	-	-
70	108,0	105,00	30,0	14,0	90,0	5,0	144,0	140,00	30,0	14,0	110,0	6,0	-	-	-	-	-	-
72	-	-	-	-	-	-	-	-	-	-	-	-	-	-	-	-	-	-
75	-	-	-	-	-	-	-	-	-	-	-	-	-	-	-	-	-	-
80	123,0	120,00	30,0	14,0	106,0	5,0	-	-	-	-	-	-	-	-	-	-	-	-
85	-	-	-	-	-	-	-	-	-	-	-	-	-	-	-	-	-	-
90	133,0	135,00	30,0	14,0	118,0	5,0	-	-	-	-	-	-	-	-	-	-	-	-
96	-	-	-	-	-	-	-	-	-	-	-	-	-	-	-	-	-	-
100	-	-	-	-	-	-	-	-	-	-	-	-	-	-	-	-	-	-
110	-	-	-	-	-	-	-	-	-	-	-	-	-	-	-	-	-	-
120	-	-	-	-	-	-	-	-	-	-	-	-	-	-	-	-	-	-
130	-	-	-	-	-	-	-	-	-	-	-	-	-	-	-	-	-	-
140	-	-	-	-	-	-	-	-	-	-	-	-	-	-	-	-	-	-